

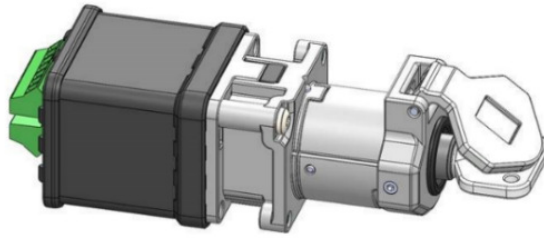

# CONTROL SWITCH – Types SS-CS and M-CS

## Operating Instructions



The CS series are a Trapped Key operated control switch designed to turn off machine control circuits. The Key is trapped when the main control contacts are closed (machine able to run). Turning the key opens the main control contacts and allows the key to be removed.

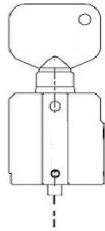

### Machine able to run condition:

Key inserted and turned to trapped position.  
11/12, 21/22, 31/32, 41,42 are closed (control contacts).  
53/54, 63,64 are open (auxiliary contacts).

### Turning the key:

11/12, 21/22, 31/32, 41,42 will open (control contacts).  
53/54, 63/64 will close (auxiliary contacts).  
Key can be removed.

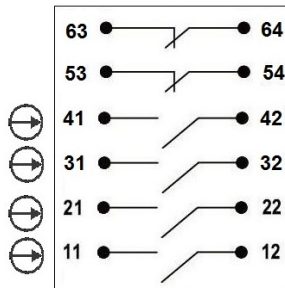

### Dimensions (mm):

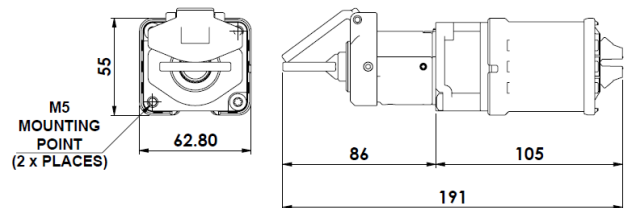
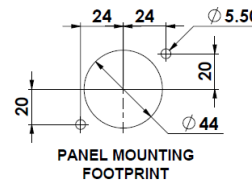

### Technical specifications:

Insulating housing: Polyester  
Construction: Stainless steel or Die Cast  
Operating Temperature: -20C. to +40C.  
Mechanical Life (B10d): 1,000,000 cycles  
Output Contacts: Rated 240V. 3A. (A300)

### Information with regard to UL Standards:

Type 1 enclosure. Maximum temperature 40°C.  
Use 16-28AWG stranded copper conductors (rated 90°C).  
Terminal Torque 6 lb ins. (0.7Nm).  
Intended for same polarity use. A300 Pilot Duty. 240V. 3A.  
PF 0.38 or greater, tested for 6,000 cycles endurance



**WARNING: DO NOT DEFEAT, TAMPER, OR BYPASS THE SAFETY FUNCTION. FAILURE TO DO SO CAN RESULT IN DEATH OR SERIOUS INJURY.**

**AVERTISSEMENT: NE PAS DESACTIVER, MODIFIER, RETIRER, OU CONTOURNER CETI INTERVERROUILLAGE IL PEUT EN RESULTER DES BLESSURES GRAVES DU PERSONNEL UTILISATEUR.**

Sales Part Number	Type	Description
M-CS	CS	4NC / 2NO Die-Cast
SS-CS	CS	4NC / 2NO Stainless Steel

### READ AND UNDERSTAND THESE INSTRUCTIONS BEFORE INSTALLING, OPERATING, OR MAINTAINING THIS EQUIPMENT.

The product is designed to be a component of a customized safety oriented control system. It is the responsibility of the user to ensure the correct overall functionality of its systems and machines. IDEM, its subsidiaries and affiliates, are not in a position to guarantee all of the characteristics of a given system or product not designed by IDEM.

**INSTALLATION:** Installation must only be carried out by competent personnel and in accordance with these instructions. Always use correct size metal mounting bolts (M6). Tightening torque 2Nm.

**IMPORTANT: ALWAYS OBSERVE ELECTRICAL RATINGS.**

**MAINTENANCE:** Every month: Check all circuits for correct function. If the key or housing display signs of mechanical damage then remove and replace. IDEM will not accept responsibility for failure of the switch functions if the installation and maintenance requirements are not implemented. THESE INSTRUCTIONS FORM PART OF THE PRODUCT WARRANTY.

# CONTROL SWITCH – Types SS-CS and M-CS

## Mounting Enclosure Dimensions (mm)

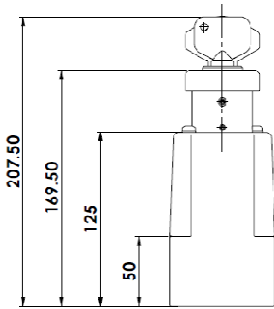

**POLYCARBONATE  
BOX MOUNT  
ENCLOSURE: B-1WAY**

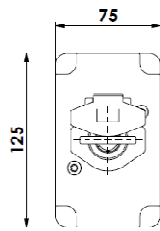

**STAINLESS STEEL  
PANEL MOUNT  
ENCLOSURE: P-2WAY**

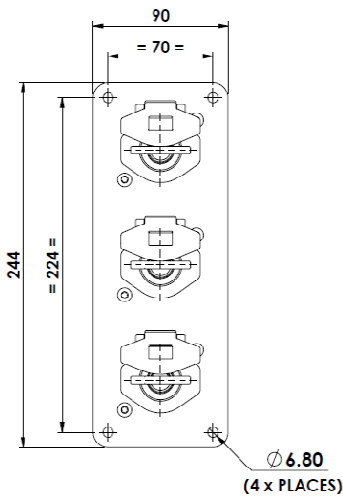
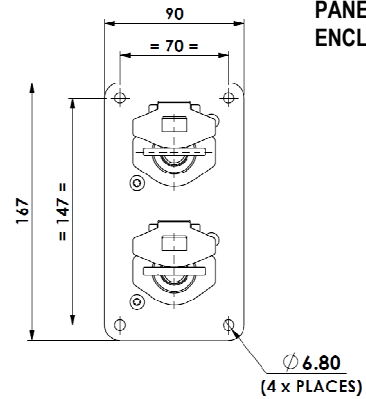

**STAINLESS STEEL  
PANEL MOUNT  
ENCLOSURE: P-3WAY**

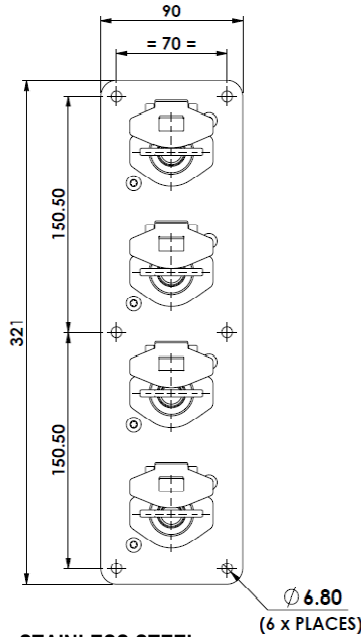

**STAINLESS STEEL  
PANEL MOUNT  
ENCLOSURE: P-4WAY**

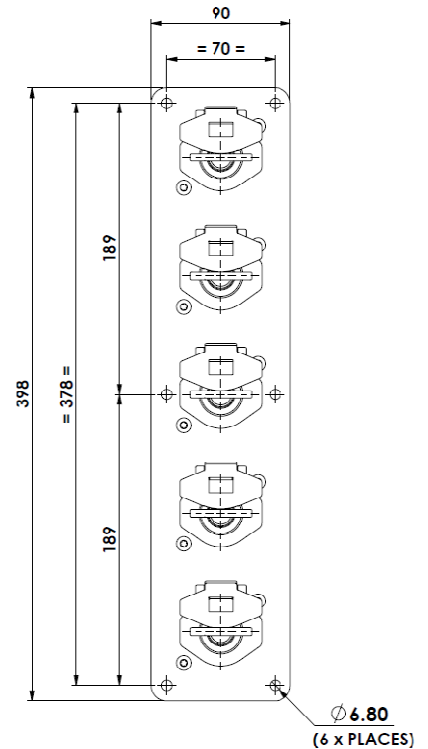

**STAINLESS STEEL  
PANEL MOUNT  
ENCLOSURE: P-5WAY**

Sales Part Number	Enclosure Panel Mount
P-2WAY	Panel Mount Kit 2 way
P-3WAY	Panel Mount Kit 2 way
P-4WAY	Panel Mount Kit 2 way
P-5WAY	Panel Mount Kit 2 way
P-6WAY	Panel Mount Kit 2 way
P-7WAY	Panel Mount Kit 2 way
P-8WAY	Panel Mount Kit 2 way
P-9WAY	Panel Mount Kit 2 way
P-10WAY	Panel Mount Kit 2 way

Sales Part Number	Enclosure Box Mount
B-2WAY	Box Mount Enclosure Kit 2 way
B-3WAY	Box Mount Enclosure Kit 3 way
B-4WAY	Box Mount Enclosure Kit 4 way
B-5WAY	Box Mount Enclosure Kit 5 way

System Arrangements: CS can be assembled into a wide range of housing options, both in box and panel mount format. CS can be mechanically interlocked with any combination of CS (control switch) or CS-SKR (Key Release) units, to provide a wider control isolation and exchange system. Please contact [technical@idemsafety.com](mailto:technical@idemsafety.com) for further information on pre-assembled systems.  
NOTE: All system arrangements are factory assembled to individual customer requirements.  
For larger systems, please contact IDEM SAFETY SWITCHES.



# SOLENOID CONTROL SWITCH – Types SS-CS-SKR and M-CS-SKR

## Operating Instructions

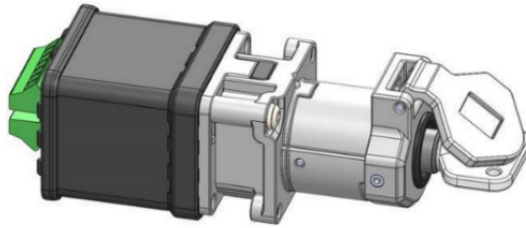

The CS-SKR series are a Trapped Key operated control switch designed to turn off machine control circuits. The Key is trapped when the main control contacts are closed (machine able to run) and can only be released when the internal solenoid in the CS-SKR is energised. This then enables the key to be turned and released and the remaining control contacts opened. The key can then be removed. It can be used in conjunction with delay timers to allow a delay before the solenoid is energised therefore allowing for any machine run down prior to releasing of the key.

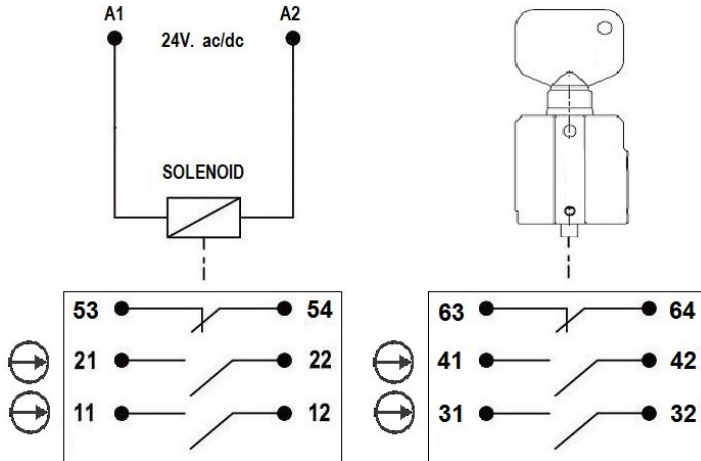

### Machine able to run condition:

No power applied to A1 and A2.  
Key inserted and turned to trapped position.  
11/12, 21/22, 31/32, 41,42 are closed (control contacts).  
53/54, 63,64 are open (auxiliary contacts).

### Applying 24V.dc to A1 and A2:

Energises the solenoid.  
11/12 and 21/22 will open (control contacts).  
53/54 will close (auxiliary contacts).  
Key can be turned and removed.

### Turning and removing the key:

31/32 and 41/42 will open (control contacts).  
63/64 will close (auxiliary contacts).

### Technical specifications:

Insulating housing: Polyester  
Construction: Stainless steel or Die Cast  
Operating Temperature: -20C. to +40C.  
Mechanical Life (B10d): 1,000,000 cycles  
Solenoid Voltage: 24V.dc (+/- 10%)  
Output Contacts: Rated 240V. 3A. (A300)

### Dimensions (mm):

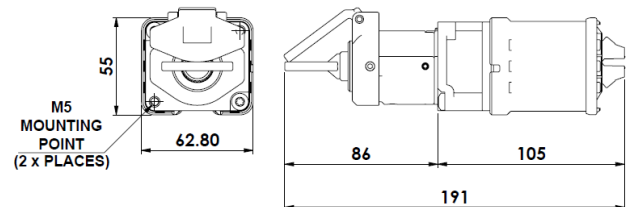
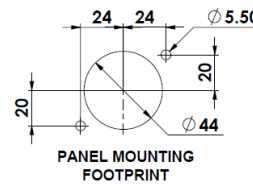

### Information with regard to UL Standards:

Type 1 enclosure. Maximum temperature 40°C.  
Use 16-28AWG stranded copper conductors (rated 90°C).  
Terminal Torque 6 lb ins. (0.7Nm).  
Intended for same polarity use. A300 Pilot Duty. 240V. 3A.  
PF 0.38 or greater, tested for 6,000 cycles endurance



**WARNING: DO NOT DEFEAT, TAMPER, OR BYPASS THE SAFETY FUNCTION. FAILURE TO DO SO CAN RESULT IN DEATH OR SERIOUS INJURY.**

**AVERTISSEMENT: NE PAS DESACTIVER, MODIFIER, RETIRER, OU CONTOURNER CETI INTERVERROUILLAGE IL PEUT EN RESULTER DES BLESSURES GRAVES DU PERSONNEL UTILISATEUR.**

Sales Part Number	Type	Description
M-CS-SKR	CS-SKR	4NC / 2NO Die-Cast with solenoid control
SS-CS-SKR	CS-SKR	4NC / 2NO Stainless Steel with solenoid control

### READ AND UNDERSTAND THESE INSTRUCTIONS BEFORE INSTALLING, OPERATING, OR MAINTAINING THIS EQUIPMENT.

The product is designed to be a component of a customized safety oriented control system. It is the responsibility of the user to ensure the correct overall functionality of its systems and machines. IDEM, its subsidiaries and affiliates, are not in a position to guarantee all of the characteristics of a given system or product not designed by IDEM.

**INSTALLATION:** Installation must only be carried out by competent personnel and in accordance with these instructions. Always use correct size metal mounting bolts (M6). Tightening torque 2Nm.

**IMPORTANT:** ALWAYS OBSERVE ELECTRICAL RATINGS.

**MAINTENANCE:** Every month: Check all circuits for correct function. If the key or housing display signs of mechanical damage then remove and replace. IDEM will not accept responsibility for failure of the switch functions if the installation and maintenance requirements are not implemented. THESE INSTRUCTIONS FORM PART OF THE PRODUCT WARRANTY.

# SOLENOID CONTROL SWITCH – Types SS-CS-SKR and M-CS-SKR

## Mounting Enclosure Dimensions (mm)

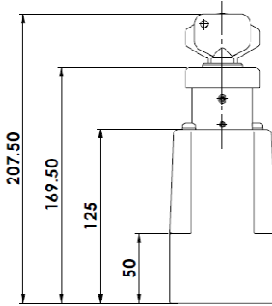

**POLYCARBONATE  
BOX MOUNT  
ENCLOSURE: B-1WAY**

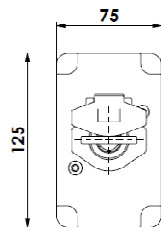

**STAINLESS STEEL  
PANEL MOUNT  
ENCLOSURE: P-2WAY**

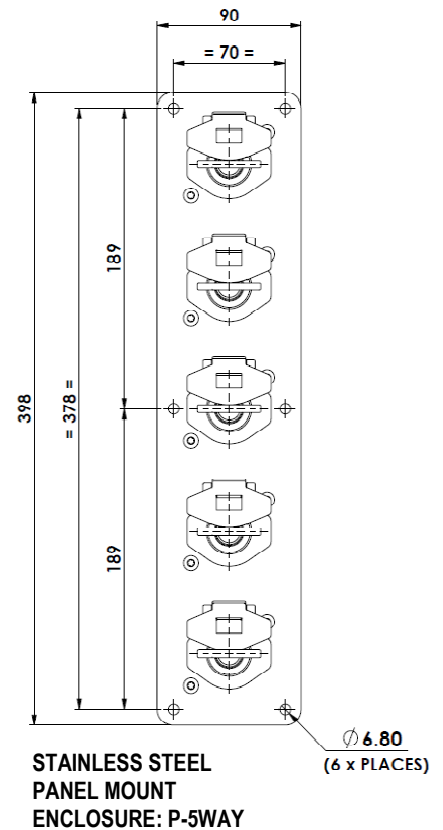
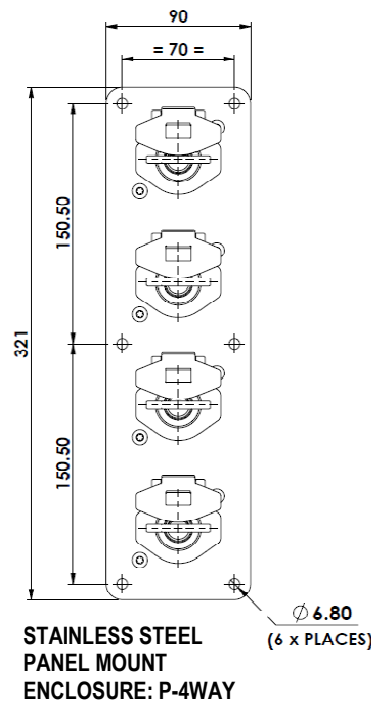
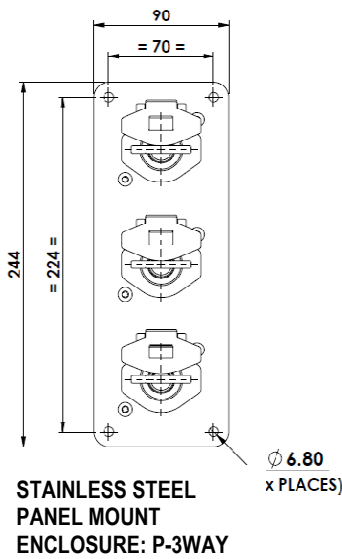
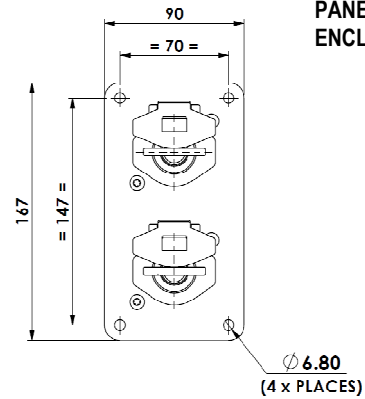

Sales Part Number	Enclosure Panel Mount
P-2WAY	Panel Mount Kit 2 way
P-3WAY	Panel Mount Kit 2 way
P-4WAY	Panel Mount Kit 2 way
P-5WAY	Panel Mount Kit 2 way
P-6WAY	Panel Mount Kit 2 way
P-7WAY	Panel Mount Kit 2 way
P-8WAY	Panel Mount Kit 2 way
P-9WAY	Panel Mount Kit 2 way
P-10WAY	Panel Mount Kit 2 way

Sales Part Number	Enclosure Box Mount
B-2WAY	Box Mount Enclosure Kit 2 way
B-3WAY	Box Mount Enclosure Kit 3 way
B-4WAY	Box Mount Enclosure Kit 4 way
B-5WAY	Box Mount Enclosure Kit 5 way

System Arrangements: CS-SKR can be assembled into a wide range of housing options, both in box and panel mount format. CS-SKR can be mechanically interlocked with any combination of CS (control switch) or CS-SKR (Key Release) units to provide a wider control isolation and exchange system. Please contact [technical@idemsafety.com](mailto:technical@idemsafety.com) for further information on pre-assembled systems.

NOTE: All system arrangements are factory assembled to individual customer requirements.

For larger systems, please contact IDEM SAFETY SWITCHES.